

# lemeego

## MANUAL

This manual will provide precision instructions. Please make sure you read this carefully before you take your first ride. If you any doubt about the information contained in these instructions, please contact us or your local distributor.

### Meet Your Lemeego E-Bike

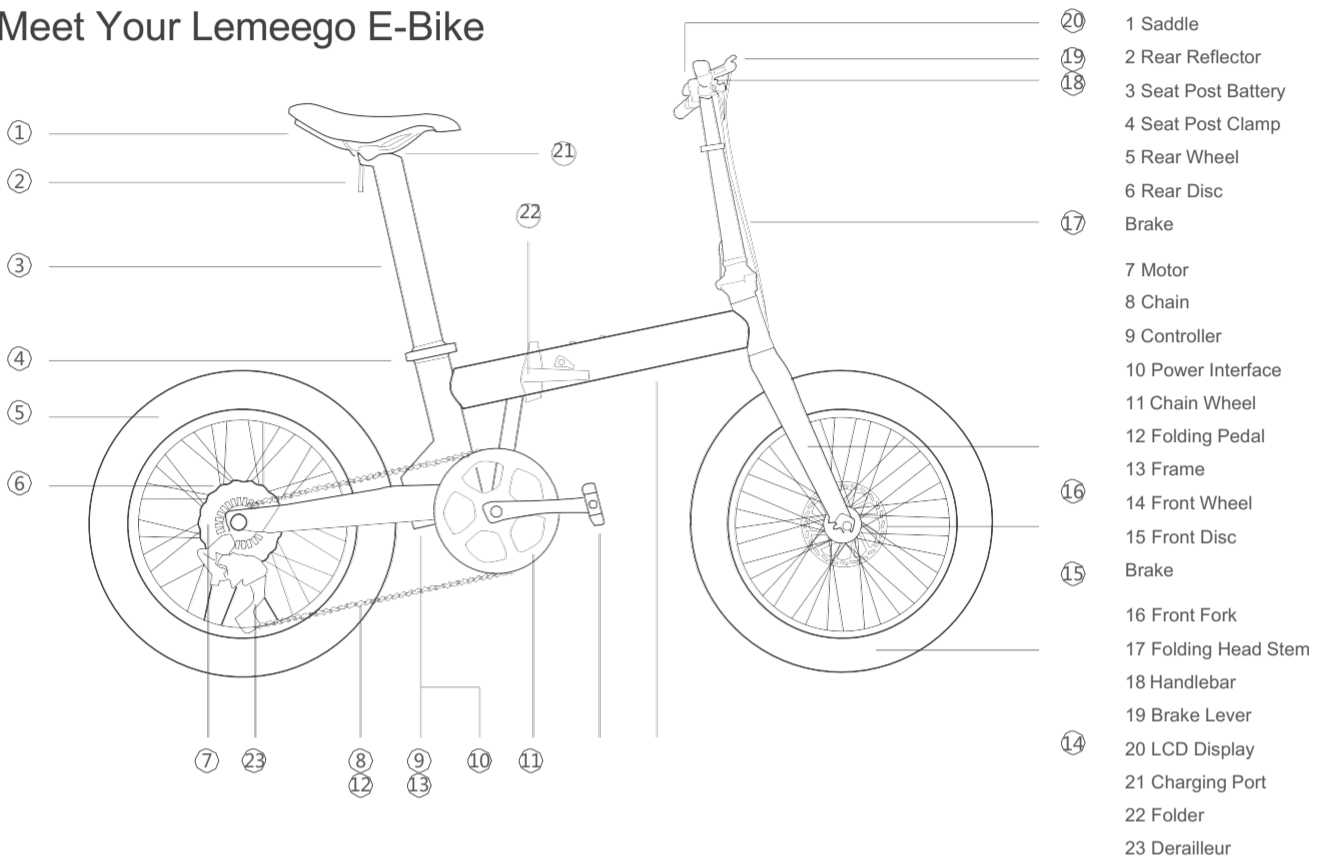

### Specifications

Product Name: Lemeego X & SE-Bike

Model Name: QSEB04

Size: 1660\*640\*1180mm

Folded Size: 900\*550\*750mm

Wheel Base: 1100mm

Net Weight: 28.5kg

Range: 100km

Max. Load: 150kg

Max. Speed: 25km/h

Charging Time: 5 Hrs

Battery Type: LG Lithium-ion

Battery Capacity: 48V 15Ah

Noise : ≤ 62 dB(A)

Motor : MXUS 500W Brushless Geared DC Motor

Rated Output Power: 500W

Motor Efficiency: ≥78%

Rated RPM: 310±10r/min

Rated Voltage: 48V

Max Torque: 40N.m

Overcurrent Protection: 15±1A

Low-Voltage Protection: 30±1V

Kwh: ≤1.2Kw.h

Modes: 5 levels

Tire Diameter: 20 inch

Frame: 20 inch 6061 Al-Alloy Foldable

Front Fork: 20 inch 6061 Al-Alloy

Brakes: 160mm disc brakes

Rim: 20 inch Al-Alloy 12G36H

Tire: CST 20\*2.4 / Innova 20\*4.25

Chain wheel: Prowheel 52T

Free Wheel: Shimano 14-28T

Derailleur: Shimano 7 speed

Chain: KMC

Handle Bar: Promax

Display: Kunteng LCD

Controller: Kunteng sine wave FOC

Brake Levers: Al-Alloy E-Bike Lever

Saddle: KNUS

Pedal: Foldable Pedals

### Fold your E-Bike

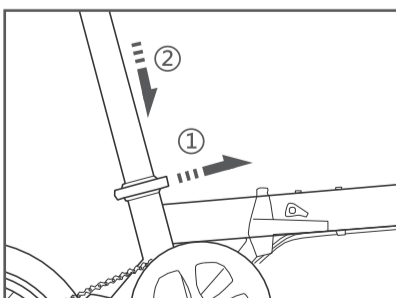

1. Grab the seat post (important) and loosen the clasp.
2. Push the seat post towards the ground slowly, tighten the seat post clamp after reaching your desired height

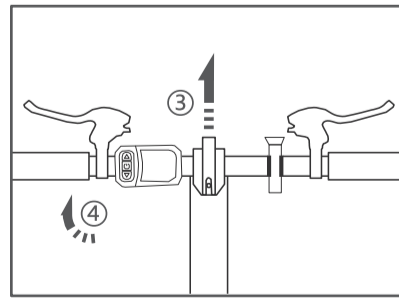

3. Loosen the handle bar clamp.
4. Turn the handlebar clockwise till vertical ,tighten the clamp.

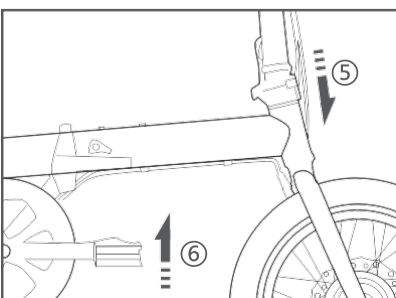

5. Release the lock clamp, fold the head tube.
6. Fold the pedal by pushing it level.

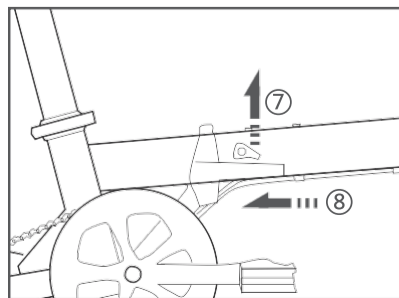

7. Release the safety cap.
8. Pull the lock bar ,fold the main tube.

# Operate your E-bike

I Press & hold the power button for 3 seconds, the LCD shows screen A, data will now show: Single Riding Time - PAS Class-Speed-SingleRange;

II Press power button once, the LCD will show screen B, data now shows: Total Riding Time - PAS class – Average Speed-Total Range;

III Press power button twice, LCD shows screen C, data now shows: Total Riding Time - Max Speed-Voltage

Touch & hold power button to turn off

▲ Up      ⏻ Power      ▼ Down      ☰ LCD backlight      🚴 Cruise Control Mode

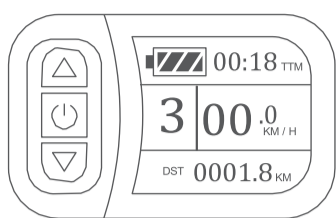

I

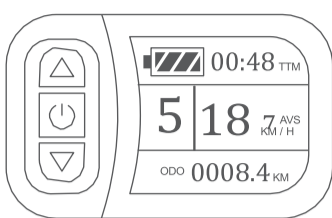

II

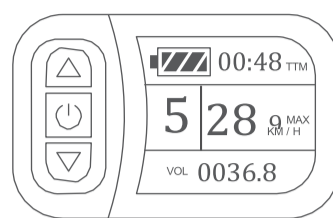

III

1. Cruise Control Mode: Press & hold DOWN button until 🚴 flickers, your e-bike is now in cruise control mode at a fixed speed of 6KM/H, tap the break or press any button to end cruise control mode at any time.
2. Cruise control mode: ride your e-bike to your desired speed (must be over 7KM/H), then press & hold DOWN button for 3 sec to enter cruise control mode, tap the break or press any button to end cruise control mode at any time.
3. LCD Backlight & Headlight: Press & hold UP button to turn on backlight, press & hold UP button again to turn off.
4. PAS Mode: Press UP or DOWN button to choose PAS classes from 0-5.

## Charge Your E-Bike

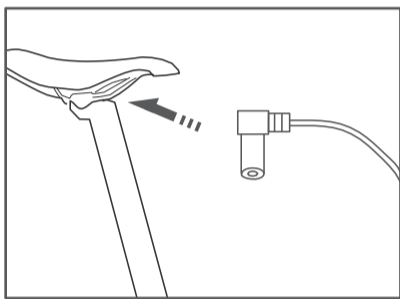

The charging port is right beneath the saddle, covered by a rubber dust free cover, uncover it, plug in the charger into the port, cover the port again when finished charging.

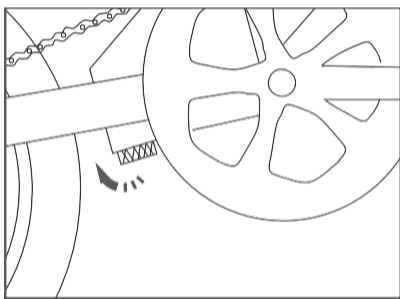

If you want to charge your battery separately, roll out the power port, release the seat post clamp, pull out the seat post battery, then repeat the above steps

## Accessory list

- 1 Front Mud Fender
  - 2 Rear Mud Fender
  - 3 Reflectors
  - 4 Bell
  - 5 Headlight
- Please mount accessories according to your needs.

## Attention

### Battery & Charge

1. Red indicator on the charger means charging, when the light turns green, please stop charging your battery;
2. Do not expose to temperature  $-20^{\circ}\text{C} < \text{ or } > 35^{\circ}\text{C}$  · Fully charge the battery and store separately if not in use for over 30 days. Fully charge the battery every 60 days, or the battery may self-discharge and be damaged. This damage is not covered by the Limited Warranty;
3. Never expose your battery to damp environments or soak into water, and never short circuit the battery terminals, this damage is not covered by the Limited Warranty;
4. Charge with the original charger only;
5. Do not disassemble/punch the battery pack. Do not place it in fire or drop from high heights and avoid contacting with similar contacts;
6. Turn off e-bike's power before you charge it. Plug the charge port in first then the AC plug;
7. Do not cover any items on the charger during charging;
8. Pull out charge port before the AC plug;
9. Please keep battery outreach from children.
10. The capacity of Li-battery will decrease when  $-10^{\circ}\text{C} <$ ;
11. Recycle or dispose of in accordance with local regulations.

### Ride & Maintenance

1. You must with your helmet on and follow the local laws and regulations ;
2. Read these instruction carefully before riding a e-bike;
3. Start your ride with the 2nd PAS class ;
4. Keep the lamp on at night ;
5. Fully check the brake system, tire pressure, and the remaining battery power before riding ;
6. PLEASE do take use front brake FIRST, ALWAYS use break first then front break ;
7. Do not use for intense riding ;
8. Do not ride into water over 15cm ;
9. Replace the quick-wear parts (like brake pad) in due time ;
10. Juveniles, Pregnant women and Intoxicants are not allowed to ride e-bike ;
11. Keep your e-bike away from damp, high temperature or corrosive environment ;
12. Keep your e-bike away from sun-scorched and rain-drenched areas ;
13. Check screws, chain and other parts regularly.